

novita

BH90/BH93/BH80/BH83

Instruction and Installation Manual

Contents

	Before using the product	How to install	How to use	Before making a service call & How to take care of the product
Safety Instructions	2 ~ 5			
Grounding Instructions	6			
Operational Instructions	8			
Descriptions of each part and accessories	9 ~ 11			
Accessories	11			
Installation Instructions	12 ~ 14			
Things that must be checked after installation	15			
How to install remote controller	16			
How to install in the public toilet	17			
How to use remote controller	18 ~ 24			
How to use main unit control panel	25 ~ 26			
How to take care of this product	27 ~ 28			
How to clean nozzle	29 ~ 30			
Prevention of Freezing	31 ~ 32			
Flickering Warning Lamp	32			
Before making a call for product service	33 ~ 34			
Specification	35			



- Before using this product, read this manual carefully and fully understand the safety and operational instructions so that the product may be used safely and adequately.
- Keep this manual in a proper place so that it may be immediately available to future reference.
- Use the genuine water filter only. Manufacturer shall not be responsible for any problem resulting from use of any filters other than the genuine filter.

Safety Instructions

Be sure to observe the following

- Be sure to read the following safety instructions carefully, and use the product only as instructed in this manual to prevent bodily injuries and/or property damage which might happen while using this product.
- Thoroughly understand each of the following symbols (marks and graphical signs), read all instructions and precautions and follow them.

	WARNING Failure to observe any of the following might result in critical injury or death.		CAUTION Failure to observe any of the following might result in minor injury and/or product damage.
	Strictly prohibited.		Be sure to unplug the electric power plug.
	Never disassemble or modify this product.		Do not place in or drop into water.
	Proper grounding required to prevent electric shock.		Things that have to be observed.
	Never use wet hands.		

- *1 : Serious injury includes loss of eyesight, severe wound, burn (high, low temperature), electric shock, bone fracture, poisoning, etc. leaving aftereffect and requiring hospitalization or regular hospital visit for a long time for recovery
- *2 : Injury means minor wound, burn or electric shock that does not require hospitalization or regular hospital visit for a long time for recovery
- *3 : Property damage refers to extensive damage relating to house, furniture, livestock or pet, etc.

Exemption from liability

- Manufacturer takes no responsibility for any damages resulting from natural disasters such as earthquakes, lightning and wind damage and flooding, fires not caused by the manufacturer or the bidet product covered by this manual, other accidents, consumer mistakes and/or misuse and abuse of the product or the use of the product under abnormal conditions.
- Manufacturer takes no responsibility for any incidental damages resulting from the use of the product or inability to use the product (lost profits or suspension of business, etc.).
- Manufacturer takes no responsibility for any damages resulting from the failure to observe the contents contained in this manual.

WARNING

When a child, the elderly or the invalid uses the product, the seat temperature adjustment button should be set to OFF position.

Kids, the elderly, people with sensitive skin, people incapable of adjusting temperature on their own, people who have taken sleep-inducing medicine (sleeping pill or cold medicine, etc.) or people with hangover or severe weariness may sustain low temperature burn or injury.



CAUTION

Do not scratch, crack, bend forcibly, twist or pull the electrical power cord. Do not apply heat to, or place heavy objects on, the cord.

Damaged power cord may lead to fire or electrical shock. Do not attempt to replace a damaged power cord on your own. Contact a nearest authorized service center for replacement.

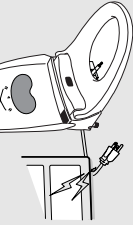

Prohibited

This product should be used with AC120 V only and electrical outlet with rated ampere of 15 ampere or higher. Use of other rated voltage than AC 120 V and/or multi-prong outlet adapter or power extension cord with other appliances may lead to fire or electric shock.

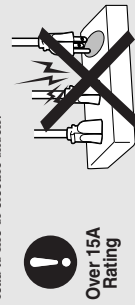

Over 15A Rating

Never disassemble, repair or modify the product.

Doing so may cause fire, electrical shock or injury. Contact a nearest authorized service center for repair.



Disassembly Prohibited

Never use a damaged power cord, damaged power plug, or a loose electrical outlet.
Doing so may result in fire, electric shock, short circuit, smoke generation or ignition.

Prohibited

Power plug should be plugged into the wall outlet securely.
Failure to do so may result in electric short circuit, electric shock, smoke generation or ignition.

Insert securely

Disconnect the power plug from the wall outlet and drain water from water tank in the case that the product is not used over an extended period of time.
If not drained, the water may be contaminated.

Drain water

Do not water the product. Do not install the product in wet or damp places. (This product is intended for use in toilet only, and should not be used for any other purpose.)
Failure to observe may lead to electric shock, electric short circuit or fire.

Prohibited

Use tap water or portable water only.
Using recycled water or industrial water may cause cystitis or irritation to skin.

Use tap water

Do not spray water or wastewater into the unit or power plug.
Doing so may cause fire or electric shock.

Prohibited

Keep the power plug dust-free by removing the dust using a dry cloth.
Failure to do so may cause a fire.

Wipe off

When plugging and unplugging the power plug, never use wet hands.
Doing so may lead to electric shock.

Wet hands prohibited

Before using the product

When cleaning the product, always disconnect the power plug from the wall outlet.

Failure to do so may result in electric shock or injury.

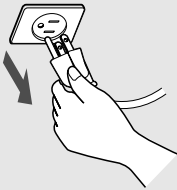

Disconnect power plug

Discontinue using the product in case of malfunctioning. Disconnect the power plug from the electrical outlet and close the water valve if any of the following occurs:

- Water leaks from either the main unit or the water pipe.
- The product makes a strange noise or produces unpleasant odor.
- The product is unusually hot.
- The product is cracked or broken.
- Smoke is released from the product.

Continued use of the malfunctioning product as mentioned above may lead to fire, electric shock or water leakage. Contact the nearest authorized service center for repair.

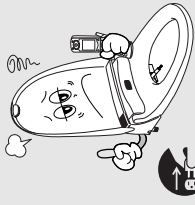

Disconnect power plug

Prohibited

Never use other water filter than the genuine filter provided by the manufacturer.

Safety Precaution

CAUTION

Use this product only as instructed in this manual.

Failure to do so may lead to fire, electric shock or injury.

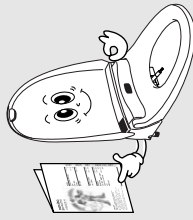

Prohibited

Never unplug the power cord by pulling on the cord. To unplug, hold the plug firmly while disconnecting the plug.

Failure to do so may result in electric shock, electric short circuit or fire.

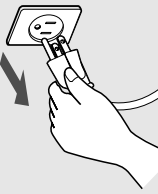

Disconnect power plug

Do not place or use the product near fire sources such as stove, heater and lit cigarette.

This may cause fire, product discoloration or malfunctioning.

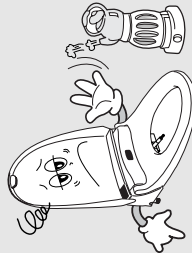

Prohibited

Do not rest against the seat cover while sitting on the seat.

This may cause the seat cover to break, which may further lead to the back injury if the user loses his/her balance and tumbles over.



Prohibited

Do not insert fingers into or block off the warm air blower outlet.

Doing so may result in burn or injury.

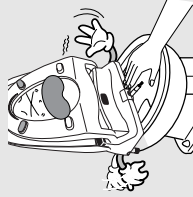

Prohibited

When a child alone uses the product, he/she may fall into the toilet bowl.

A child should be accompanied and attended by an adult.



Prohibited

Do not insert fingers or other objects into any product openings such as warm air outlet or nozzle gate.

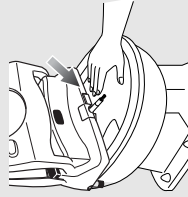

CAUTION

Be sure to press the buttons on the control panel only while the seat is occupied.

Otherwise, toilet room floor may get wet with warm water coming out from nozzle.

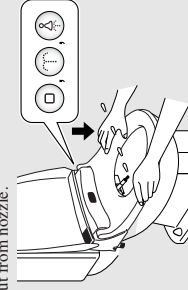

CAUTION

Close water valve before removing the filtering mesh for cleaning.

Make sure that there is no water leakage after the mesh is re-installed tightly following the cleaning.

Failure to observe may lead to water leakage.

(See page 27 for cleaning of the filtering mesh.)

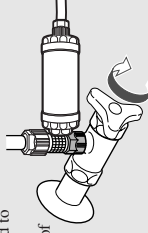

Close

Never expose the product to direct sunray. Doing so may result in worsening of product surface such as discoloration or fading and/or product degradation.

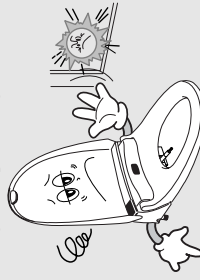

Prohibited

Do not pull forcibly, or apply excessive force to, the water feed hose.

Doing so may cause water to leak.

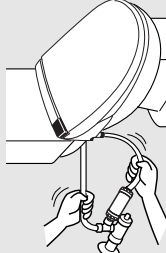

Prohibited

Do not stand on, or give a shock to, the main unit.

Doing so may lead to deformation or breakage of the product, further resulting in bodily injury.

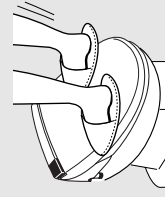

Prohibited

Before using the product

GROUNDING INSTRUCTION

1. This product should be grounded. In the event of an electrical short circuit, grounding reduce the risk of electric shock by providing an escape wire for the electric current. This product is equipped with a cord having a grounding wire with a grounding plug. The plug must be plugged into an outlet that is properly installed and grounded.

Danger - Improper use of the grounding plug can result in a risk of electric shock.

If repair or replacement of the cord or plug is necessary, do not connect the grounding wire to either flat blade terminal. The wire with insulation having an outer surface that is green with or without yellow stripes is the grounding wire.

Check with a qualified electrician or serviceman if the grounding instructions are not completely understood, or if in doubt as to whether the product is properly grounded.

2. This product is for use on a nominal 120 V circuit, and has a grounding plug that looks like the plug illustrated in sketch A in Figure 1. A temporary adapter, which looks like the adapter illustrated in sketches B and C, may be used to connect this plug to a 2-pole receptacle as shown in sketch B if a properly grounded outlet is no available. The temporary adapter should be used only until a properly grounded outlet (sketch A) can be installed by a qualified electrician. The green colored rigid ear, lug, and the like extending from the adapter must be connected to a permanent ground such as a properly grounded outlet box cover. Whenever the adapter is used, it must be held in place by the screw.

3. If it is necessary to use an extension cord, use only a three wire extension cord that has a three-blade grounding plug, and a three-slot receptacle that will accept the plug on the product. Replace or repair a damaged cord.

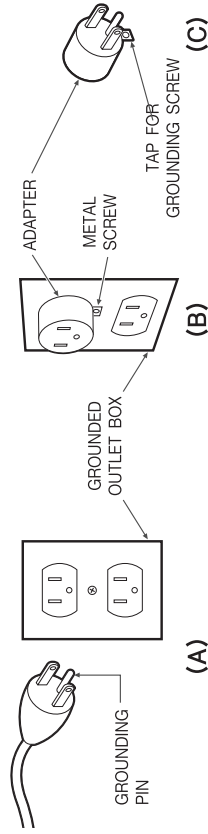

Figure 1.

Before using the product

Never use acidic or alkaline toilet detergent, benzene, thinner, cleanser or nylon scrubber when cleaning the product.
Doing so may damage plastic or metallic parts.



Prohibited

Always keep the ambient temperature above 32°F (0°C) by using a heater in the place where freezing is likely to occur.
If freezing occurs, it may result in a leakage of water pipe causing water to leak.
If freezing is highly likely to occur, drain warm water from warm water tank.

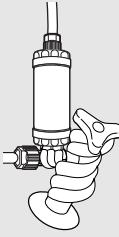

Keep warm

Do not place or drop the product in/into water.
It may lead to a product failure or electric shock.



Never place in water

Do not insert fingers or other objects into deodorization cassette housing.
Doing so may lead to injury in the fingers due to rotating deodorization fan.



Prohibited

CAUTION for usage
The user of this bidet product should not weigh more than 264.5 lbs(120kg).

CAUTION for usage
Any person having a female-specific disorder, skin disorder or disease in the personal area should consult a physician before using this product.
This product is not medical equipment.

CAUTION for usage
Water pressure setting should be positioned to 'Low' or 'Very Low' when the product is used by a person having sensitive skin or a disease in the sensitive personal area, the elderly, the invalid or the disabled.
Failure to do so may lead to damage to skin.

CAUTION for usage
Use the genuine water filter only. Manufacturer shall not be responsible for any problem resulting from use of any other filters.

CAUTION for usage
Before removing and relocating the product (in case of house moving or installing the product in a different place), be sure to close water supply valve, disconnect power plug, drain the residual water inside the product and pack the product.
• If residual water is not drained, it may lead to electric shock, fire or product failure due to leakage.
• Refer to page 30 for removing residual water.
• For details, contact the dealer where the product was purchased or service center.

Operational instructions

<p>Water supply to the toilet water tank may be interrupted if the ball-tap connecting screw is tightened, when disassembling the water pipe or connecting water feed hose.</p> <p>Do not touch ball-tap connecting screw.</p>	<p>Deodorization will stop automatically after 15 minutes of continuous use.</p> <p>Please stand up and sit again for longer use.</p> <p>The main purpose of deodorization is to remove the odor in toilet bowl. It's not for the whole bathroom.</p>
<p>Have a specialized plumber install the hot water feed pipe and the flush valve in the cold area.</p> <p>Contact specialized technician.</p> <p>Keep the unused water pipes for future use.</p>	<p>No cleansing water will be supplied from nozzle if water pressure control is set to low in the area of low tap water pressure.</p> <p>Please set the water pressure control to "high".</p>
<p>Do not open/close the toilet seat and cover using excessive force.</p> <p>Doing so may lead to breakage or malfunction.</p>	<p>Do not press the button so hard on the control panel.</p> <p>Doing so may cause malfunction.</p>
<p>When installed in the same room with bathtub without proper ventilation, steam or moisture on the sitting sensor window may cause malfunctioning.</p>	<p>Cleansing will stop automatically by the timer after about 2 minutes of continuous use.</p>
<p>Water may keep running out of nozzle after cleansing. It does not indicate abnormality. It is residual water from the inside pipes.</p> <p>It will stop after 2 minutes.</p>	<p>Keep clean the nozzle and warm air blower outlet against the possible stain from urine by a male user.</p> <p>It may cause malfunction.</p>
<p>Drain water completely out of warm water tank to prevent possible water leakage and unplug the power cord, when the product is not in use for a long time.</p>	<p>Keep clean the nozzle against the contamination.</p> <p>It may cause bad odor or malfunction.</p>
<p>Wipe up the main unit with a soft cloth when it's dirty.</p> <p>Clean with a diluted neutral detergent using soft cloth and then wipe off with the remaining with damp cloth if it is excessively dirty.</p>	<p>If the direct light or the light from inverter fluorescent lamp comes in contact with the receiver of remote controller signal, the remote controller may not operate properly.</p> <p>In such case, remove the remote controller from the holder and use it while holding with the hand.</p>
<p>Install the remote controller in the place where the signal can easily reach the signal receiver.</p>	<p>Never place the remote controller near the stove, drop or dip into water.</p> <p>Never drop the remote controller into toilet bowl.</p> <p>Doing so may lead to malfunction.</p>
<p>The remote controller may not operate properly if things like curtain are in between the controller (transmitter) and the receiver.</p>	<p>Replace batteries in the remote controller periodically. Otherwise, the remote controller may not properly operate due to weak batteries.</p>

Descriptions of each part and accessories

Numbers inside the arrow sign indicate the pages, where the corresponding parts appear.

Front side of main unit

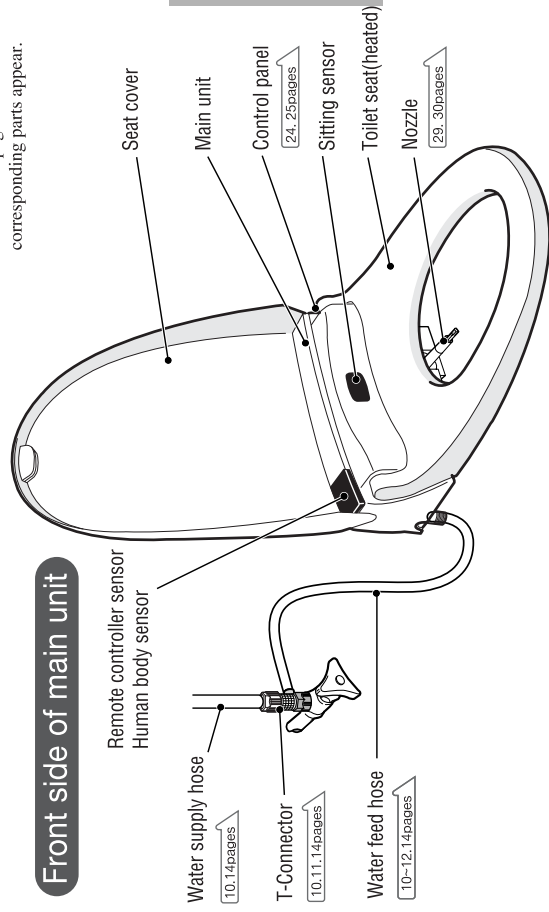

Before using the product

Rear side of main unit

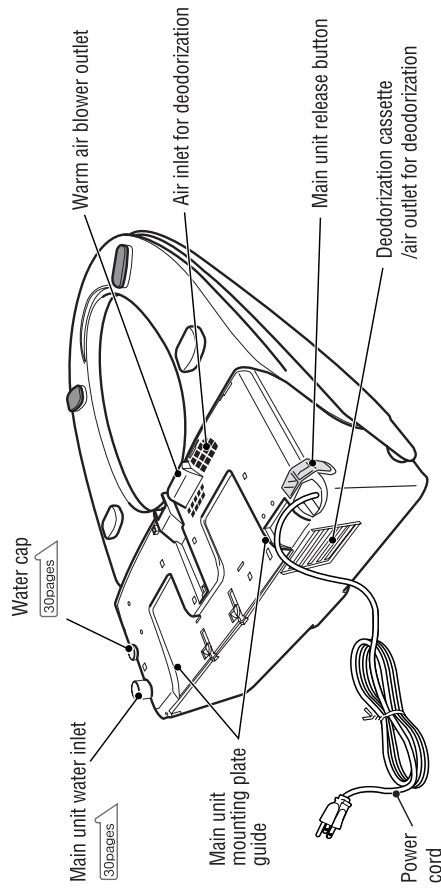

Control panel

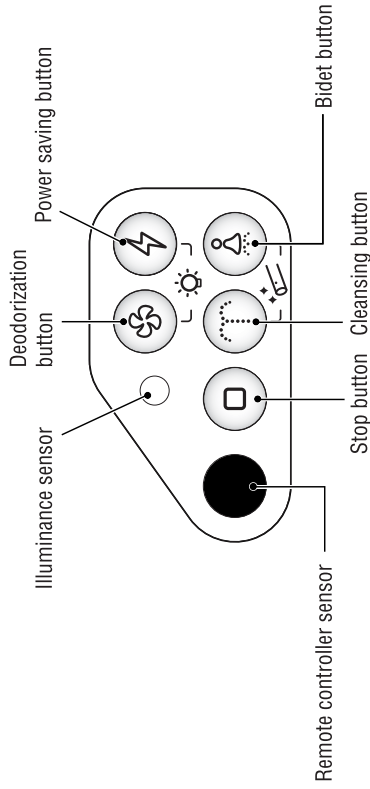

- ※ (Mood lamp): Press and hold for more than 3 seconds both deodorization and power saving buttons at the same time.
- ※ (Nozzle cleaning): Press and hold for more than 3 seconds both cleansing and bidet buttons at the same time.

Remote controller control panel

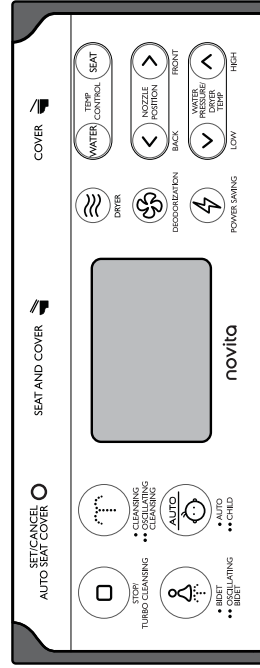

Back side of remote controller

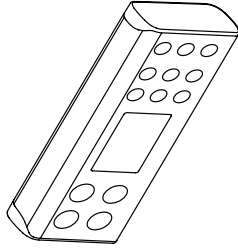

Remote controller holder

The holder in which remote controller is kept is attached to the wall.

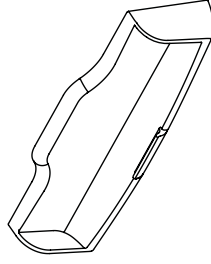

How to install

Accessories

Items required for installation

<p>Mounting bolt</p> <p>Mounting plate 2pcs</p> <p>Mounting guide 1pcs</p> <p>Mounting bolt set 1 set</p>	<p>Water tank hose 13.7m(0.35m) 1pc (includes packing)</p>	<p>Water feed hose 19.6m(0.5m) 1pc (includes packing)</p>	<p>Brush for cleaning 1pc</p>	<p>Water filter 1pc</p>
<p>Hemisphere packing</p> <p>Washer</p> <p>Nut</p>	<p>T-connector 1pc</p> <p>Packing 1pc</p>	<p>Deodorization filter 1pc</p>		

Items required for installation of remote controller

<p>Three AA batteries 1.5V</p>	<p>2 pieces of double-stick tape</p>
--------------------------------	--------------------------------------

Installation Instruction

1

Close water valve.

- Check if any appliance is used with water before closing the valve.
- Close the valve by turning the handle or using a screwdriver.

Note

- Check any nearby tap water if water dose not run after the valve is closed.

2

Remove the existing toilet seat.

- Remove the seat by untightening the nut using a tool.

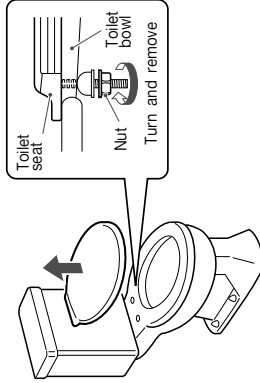

Note

- Keep the removed seat, seat cover, nuts, etc. in the safe place for future use just in case.

3

Attach T-connector valve.

Standard water valve, inner-screw type water valve

1. Connect the T-connector to the toilet water tank.

- Over-tightening by using excessive force may lead to a leakage.

2. Connect the T-connector and the water valve with the water tank hose.

- Water leakage may occur if the packing is not used when connecting.
- Hold the T-connector valve firmly when connecting the hose so that the T-connector valve does not rotate.

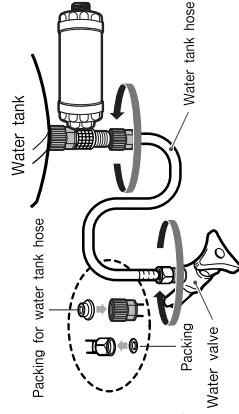

3. Connect the water filter to the T-connector.

- Make sure and check before connecting the hose that there is a packing in hose joint.
- Connect the water feed hose to T-connector, which is connected with the water valve.

4. Connect the water feed hose to the water filter.

- Make sure and check before connecting the hose that there is a packing in hose joint.

Installation Instruction

4

Connect the water feed hose.

Connect the water feed hose to the main unit.

- Check if there is the packing in the hose connection before connecting.

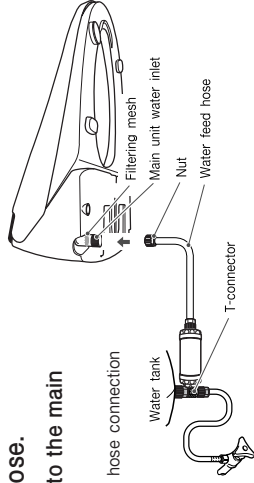

5

Install the main unit.

1. Remove hemisphere packing, washer and nut from mounting bolt, and insert the mounting bolt to the mounting plate.
2. The head of mounting bolt should come in direct contact with the mounting plate.
3. Insert mounting bolts to the toilet bowl holes while aligning the bolts to the holes, and connect hemisphere packing, washer and nut in such order.

How to install

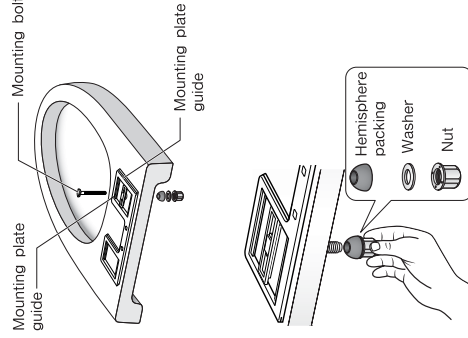

Note

- When the product is aged over time, screw bolt may get loose. In such case, tighten the nut again.

⚠ CAUTION

- ① The distance between the bolts can be adjusted in the range from 130mm to 200mm depending on the hole locations on the toilet bowl
- ② Carefully align the center of main unit to that of toilet bowl when attaching and fixing the main unit.
- ③ Use the wrench enclosed with bidet when tightening.

Installation Instruction

4. Align the center of main unit to the center of the plate guide and push all the way until 'click' sounds.

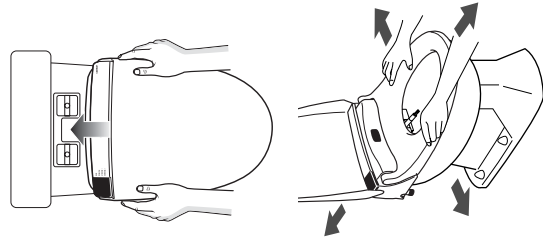

5. Check if or not the main unit easily comes off by moving the unit in four different directions.

- When the main unit is installed to toilet bowl, it may be a little movable, which does not indicate abnormality. This happens as the main unit removable type.

Note

- The main unit may become heavily movable if used over an extended period of time due to loose bolts. Fully tighten the bolt if that happens.

Inspection required after installation

Checking water leakage

Check carefully if water leaks from pipe joint or any other parts after the product installation.

Inspection items

- Check if all the packing were used in the installation. If there is any packing left, check where it is missing, disassemble the joint where it is missing and properly use it.
- Check if there is any loose connection or joint before feeding water.
If there is any loose connection, tighten using a spanner.

1. Open water valve.
2. Open water feed valve and check if water leaks from any pipe joints.

If water leaks,

1. Close water valve.
2. Disassemble the joint where water is leaking and connect properly again.

Note

- If water continues leaking, close water valve and contact a nearest authorized service center.

Check product operation

Check the operation of the product in the following order.

1. Open water valve (if closed).
2. Open water feed valve with a blade type screwdriver (or with hands if it is lever type.)
 - Check if water leaks from pipe, water tank hose or water feed hose joints.
If water leaks, close the water feed valve, separate the valve and check if rubber packing is inserted.
If not, insert the packing and reassemble the water feed valve.
3. Connect the power plug to the wall outlet.
 - Nozzle extends and retracts once, and the control panel lamps keep blinking (at initial operation.)
4. Approach the hand to the sitting sensor (within 1.9 inch (5 cm)) so that the sitting sensor may be activated.
 - Deodorization fan operates which indicates that the sitting sensor has been activated.
 - There is water around nozzle which indicates that water is inside the tank.
5. Press cleansing button.
 - Check if nozzle extends and water comes out from the nozzle. Use hands to prevent water from splashing around.
6. After confirming that warm water is coming from the nozzle, separate the hand from the sitting sensor or press stop button so that the operation may be stopped.
 - Cleansing operation stops and nozzle retracts.

How to install remote controller

1

1. Insert two AA batteries.
1. Take out the remote controller from the remote controller holder and open the battery cover on the back side.
2. Insert two AA batteries (1.5V) while paying attention to ⊕, ⊖ signs.
3. Close the battery cover.

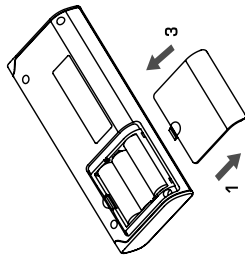

2

2. Install the remote controller on the wall.
1. Attach the double-stick tape on the back side of the holder. Red side of the tape should be visible.
* Once the holder is attached to the wall, it is difficult to remove. Therefore, it is recommended that the proper location for the remote controller to be installed should be determined before the holder is attached on the wall.

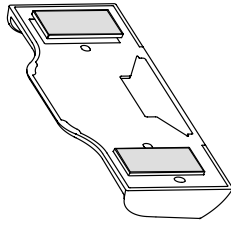

2. Thoroughly clean the area on the wall where the holder is located, remove the red cover from the double-stick tape and attach the holder to the wall.
• Signal can be better received by the receiver if the remote controller holder is located as close as possible to the main unit control panel.

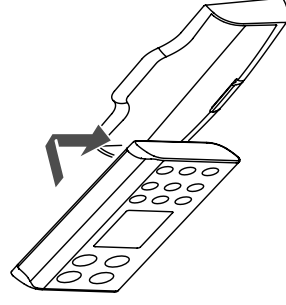

3

3. Put the remote controller into the holder.
• Check and confirm if the remote controller is properly installed in the holder.

How to install in the public toilet

This page provides the installation instruction in the event that several bidet products are installed in the public toilets such as those in hotel, shopping mall or the school, etc. where several toilet bowls are installed in a row. If the product is installed in a private usually residential toilet room, instructions in this page do not apply.
* In case of modification in installation or product settings, contact the authorized service personnel.

Initial setting of remote controller

When the bidet products are shipped out of the manufacturer's factory, any and all remote controllers have the same initial setting. Therefore, if two or more products are operated using remote controllers at the same time in the public toilet room, it may lead to product malfunction unless the remote controller settings are changed. Be sure to change the remote controller setting in the following order. A total of 8 different settings including the initial setting at the manufacturer's factory are available. (Tools that are required; precision screwdriver, nipper)

1 Remove 5 screws from the remote controller and open the back cover.

- Use precision screwdriver to remove the screws.

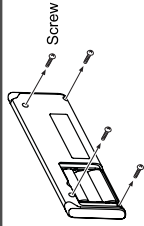

2 Change the mode by cutting jumper wire by using nipper on the circuit board.

- Jumper wire should be cut by cutter at the center, and be careful and pay attention so that wire cut may not get into the main unit. If other jumper wire on the circuit board is cut, it may lead to malfunctioning of the product.

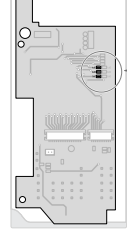

Remote controller setting table

O: No cut X: Cut * : initial mode at the time when the products are shipped out of factory

Mode of setting	OP4	OP5	OP6	OP #
0	O	O	O	0
1	O	O	X	1
2	O	X	O	2
3	O	X	X	3
4	X	O	O	4
5	X	O	X	5
6	X	X	O	6
7	X	X	X	7

Explanation on the table

- In the event that, for example, three toilet bowls are in a row of which remote controller settings are referred to 0, 1, 2 respectively. For the remote controller 0, setting does not have to be changed. For the remote controller 1, jumper wire OP4 is cut. For the remote controller 2, jumper wire OP5 is cut. (In the event that the number of toilet bowls increase, the table may still be used accordingly and jumper wire should be cut based on the table.)

3 Put back the back cover and fix with the 4 screws.

4 Once the setting change of remote controller is completed, set the main unit accordingly.

1. When the stop button is pressed and held for three seconds or more, a beep sounds once.
2. Press the stop button on the remote controller.
3. If beep sounds twice, the setting is completed.

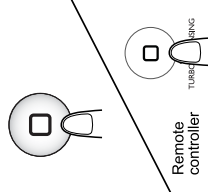

How to install